

Cabinet "U" handles

Aluminium

SPECIFICATION

Aluminium

plastic coated

black, RAL 9005, textured finish **SW**

black, RAL 9005, UV-resistant, textured finish **SWU**

red, RAL 3000, textured finish **RS**

silver, RAL 9006, textured finish **SR**

white, RAL 9016, antimicrobial **WSA**

anodized, natural colour **EL**

blank, tumbled **BL**

INFORMATION

GN 565 cabinet „U“ handles are made from a bent aluminum profile and have excellent stability and ergonomic design. Due to the production process, special designs can be supplied even in relatively small quantities.

In addition to the standard surfaces, these cabinet „U“ handles are also available with a functional coating.

The **SWU** version is coated with a highly weather-resistant and UV-protective powder coating system, making this version excellent for outdoor use.

The **WSA** version has a powder coating based on zinc molybdate, which gives it antimicrobial properties. The principle of action, which is activated by the presence of moisture, demonstrably reduces the growth of viruses, bacteria, and fungi within 24 hours, so that contaminated surfaces ultimately have less than 0.2% of the original number of microbes.

Standard elements with antimicrobial plastic coating are primarily used in the health care sector and in public buildings, such as airports, train stations, stadiums, etc.

TECHNICAL INFORMATION

- Load rating information (see page A35)

* Complete with colour index of the Cabinet "U" handles (SW, SWU, RS, SR, WSA, EL or BL)

SW **SWU** **RS** **SR** **WSA** **EL** **BL**
 RAL9005 RAL9005 RAL3000 RAL 9006 RAL9016 anodized blank

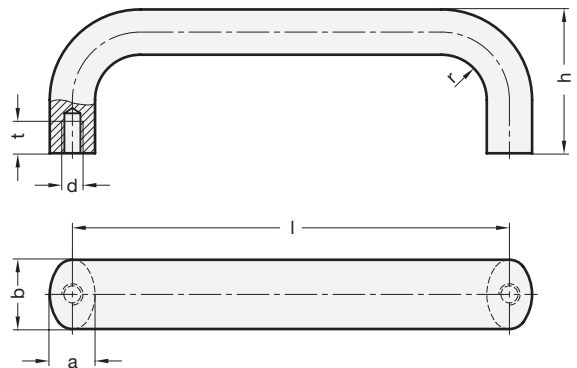

GN 565

Description	b	l ±0.25	a	d	h	r	t min.	△
GN 565-20-100-*	20	100	13	M 6	49	13	10	87
GN 565-20-112-*	20	112	13	M 6	49	13	10	93
GN 565-20-117-*	20	117	13	M 6	49	13	10	100
GN 565-20-120-*	20	120**	13	M 6	49	13	10	102
GN 565-20-128-*	20	128	13	M 6	51	13	10	103
GN 565-20-160-*	20	160	13	M 6	51	13	10	121
GN 565-20-180-*	20	180**	13	M 6	51	13	10	139
GN 565-20-200-*	20	200	13	M 6	51	13	10	150
GN 565-20-235-*	20	235**	13	M 6	51	13	10	155
GN 565-26-112-*	26	112	17	M 8	55	17	12	161
GN 565-26-117-*	26	117	17	M 8	55	17	12	166
GN 565-26-120-*	26	120**	17	M 8	55	17	12	171
GN 565-26-125-*	26	125	17	M 8	55	17	12	180
GN 565-26-128-*	26	128	17	M 8	55	17	12	180
GN 565-26-160-*	26	160	17	M 8	57	17	12	210
GN 565-26-179-*	26	179	17	M 8	57	17	12	234
GN 565-26-192-*	26	192	17	M 8	57	17	12	240
GN 565-26-300-*	26	300	17	M 8	57	17	12	345
GN 565-26-400-*	26	400	17	M 8	57	17	12	440
GN 565-26-500-*	26	500	17	M 8	57	17	12	538

** suitable for 19" rack and enclosure layout



U-Handles 4