

## Arch handles

### Aluminium

#### SPECIFICATION

Arch handle  
Aluminium  
plastic coated  
black, RAL 9005, textured finish **SW**  
silver, RAL 9006, textured finish **SR**

End pieces (for SW and SR)  
Zinc die casting  
plastic coated  
silver, RAL 9006, textured finish

Grub screw  
Steel, tensile strength class 5.8 (500 N/mm<sup>2</sup>)  
zinc plated, blue passivated

Hexagon nuts ISO 4032-M8  
Steel, zinc plated

Washers DIN 125  
Steel, zinc plated

#### TECHNICAL INFORMATION

- Load rating information (see page A35)

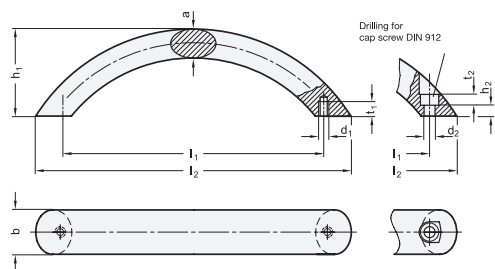
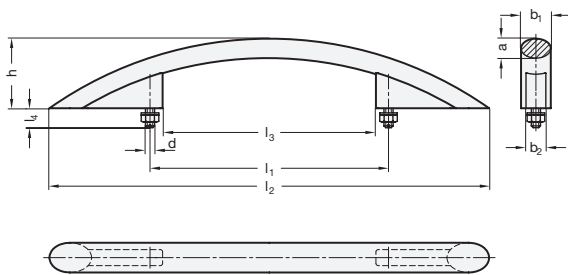

### GN 665

Description	b1	l1 ±0.25	a	b2	d	h-1	l2 ≈	l3	l4 ≈	⚖
GN 665-26-350-SW	26	350	17	14	M 8	69	526	328	17	621
GN 665-26-450-SW	26	450	17	14	M 8	69	632	428	20	699
GN 665-26-350-SR	26	350	17	14	M 8	69	526	328	17	621
GN 665-26-450-SR	26	450	17	14	M 8	69	632	428	20	699

### GN 565.9

### STAINLESS STEEL

Description	b	l1 ±0.25	l2 ≈	a	d1	d2	h1	h2	t1 min.	t2	⚖
GN 565.9-20-160-A-MT	20	160	185	13	M 6	-	50	-	8	-	318
GN 565.9-20-192-A-MT	20	192	221	13	M 6	-	50	-	8	-	366
GN 565.9-20-160-B-MT	20	160	185	13	-	5.3	50	5	-	5	306
GN 565.9-20-192-B-MT	20	192	221	13	-	5.3	50	5	-	5	350

