

SM. | Stems for levelling elements

Steel or stainless steel



STANDARD EXECUTIONS

- **SM:** zinc-plated steel spheric articulated and threaded stem with regulation hexagon.
- **SM-SST:** AISI 304 stainless steel spheric articulated and threaded stem with regulation hexagon.

NOTE

To choose the stem see "Tables of the possible combinations Bases/ Stems" on page 984.

The stems are usually supplied in a packing of four pieces compacted by means of a shrink film to avoid any damaging movement during transport.

For big quantities, the stems are supplied in wooden boxes and are placed in order, to avoid any damaging movement during transport.

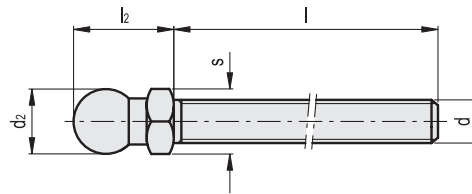

SM.



SM-SST



Code	Description	d	l	l2	d2	s	ΔΔ	Code	Description	ΔΔ
302121	SM-14-M8x43	M8	43	19.5	13.9	14	30	322121	SM-14-SST-M8x43	31
302125	SM-14-M8x68	M8	68	19.5	13.9	14	42	322125	SM-14-SST-M8x68	43
302221	SM-14-M10x43	M10	43	19.5	13.9	14	39	322221	SM-14-SST-M10x43	40
302225	SM-14-M10x68	M10	68	19.5	13.9	14	51	322225	SM-14-SST-M10x68	53
302231	SM-14-M10x98	M10	98	19.5	13.9	14	65	322231	SM-14-SST-M10x98	67
302321	SM-14-M12x43	M12	43	19.5	13.9	14	49	322321	SM-14-SST-M12x43	50
302325	SM-14-M12x68	M12	68	19.5	13.9	14	66	322325	SM-14-SST-M12x68	68
302331	SM-14-M12x98	M12	98	19.5	13.9	14	87	322331	SM-14-SST-M12x98	90
302421	SM-14-M14x68	M14	68	19.5	13.9	14	88	322421	SM-14-SST-M14x68	91
302431	SM-14-M14x98	M14	98	19.5	13.9	14	109	322431	SM-14-SST-M14x98	112
302441	SM-14-M14x148	M14	148	19.5	13.9	14	192	322441	SM-14-SST-M14x148	195
302521	SM-14-M16x68	M16	68	19.5	13.9	16	110	322521	SM-14-SST-M16x68	113
302525	SM-14-M16x108	M16	108	19.5	13.9	16	162	322525	SM-14-SST-M16x108	167
302541	SM-14-M16x148	M16	148	19.5	13.9	16	214	322541	SM-14-SST-M16x148	220
302561	SM-14-M16x168	M16	168	19.5	13.9	16	240	322561	SM-14-SST-M16x168	247
302621	SM-24-M16x58	M16	58	37	23.9	24	176	322621	SM-24-SST-M16x58	181
302625	SM-24-M16x98	M16	98	37	23.9	24	227	322625	SM-24-SST-M16x98	234
302641	SM-24-M16x138	M16	138	37	23.9	24	277	322641	SM-24-SST-M16x138	285
302661	SM-24-M16x158	M16	158	37	23.9	24	304	322661	SM-24-SST-M16x158	313
302725	SM-24-M20x98	M20	98	37	23.9	24	297	322725	SM-24-SST-M20x98	306
302741	SM-24-M20x138	M20	138	37	23.9	24	376	322741	SM-24-SST-M20x138	387
302761	SM-24-M20x158	M20	158	37	23.9	24	415	322761	SM-24-SST-M20x158	427
302781	SM-24-M20x198	M20	198	37	23.9	24	498	322781	SM-24-SST-M20x198	513
302825	SM-24-M24x98	M24	98	37	23.9	24	395	322825	SM-24-SST-M24x98	407
302861	SM-24-M24x158	M24	158	37	23.9	24	567	322861	SM-24-SST-M24x158	584
302881	SM-24-M24x198	M24	198	37	23.9	24	685	322881	SM-24-SST-M24x198	706

- 1
- 2
- 3
- 4
- 5
- 6
- 7
- 8
- 9
- 10
- 11
- 12
- 13
- 14
- 15
- RH

Levelling elements and supports