

Vertical acting toggle clamps

with dual flanged mounting base

SPECIFICATION

Types

- Type **AVF**: U-bar version, with two flanged washers
- Type **CVF**: U-bar version, with two flanged washers and GN 708.1 spindle assembly (see page 1625)
- Type **EVF**: Solid bar version, with clasp

Parts in sheet metal

Case-hardened Steel C10
zinc plated, blue passivated

Bearing pins tempered

Bearing rivets case-hardened

All moving parts

lubricated with special grease

Hand grip

High quality, oil resistant red plastic

Spindle assembly GN 708.1, Type A (see page 1625)

- Steel, zinc plated
- Rubber tip 85 Shore A



INFORMATION

GN 812.1 vertical acting toggle clamps work according to the toggle principle: lever and clamping bar move in the same direction. In the clamped position the operating lever is in its vertical position.

They can be mounted in two planes via the dual flanged mounting base and require less space for the clamping action.

Vertical acting toggle clamps in the U-bar version with two flanged washers (Type AVF) can accommodate an application specific clamping screw. A spindle assembly with neoprene rubber tip is also included for Type CVF.

Type EVF version can either be utilized by welding the clasp which can then accommodate an application specific hold-down fastener component, or by utilizing the bar in conjunction with the GN 809 (see page 1630) clamp mounts to hold the work piece in place.

- General information for toggle clamps (see page 1560)

ACCESSORY

- Spindle assemblies (see page 1623)
- GN 809 clamp mounts for toggle clamps (for Type EVF) (see page 1630)
- GN 801 clamp mounts for toggle clamps (for Type AVF) (see page 1629)

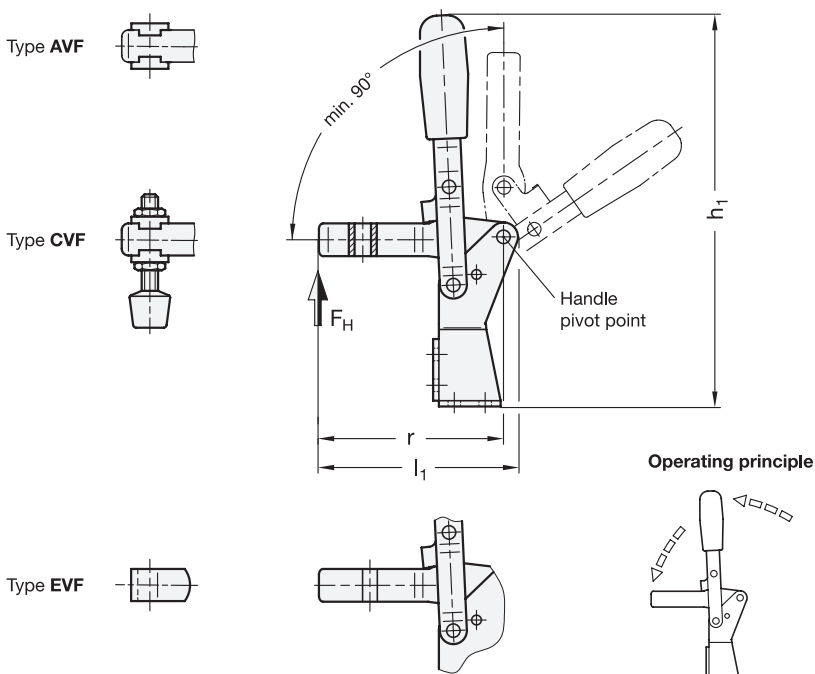

Type AVF

Type CVF

Type EVF

Operating principle

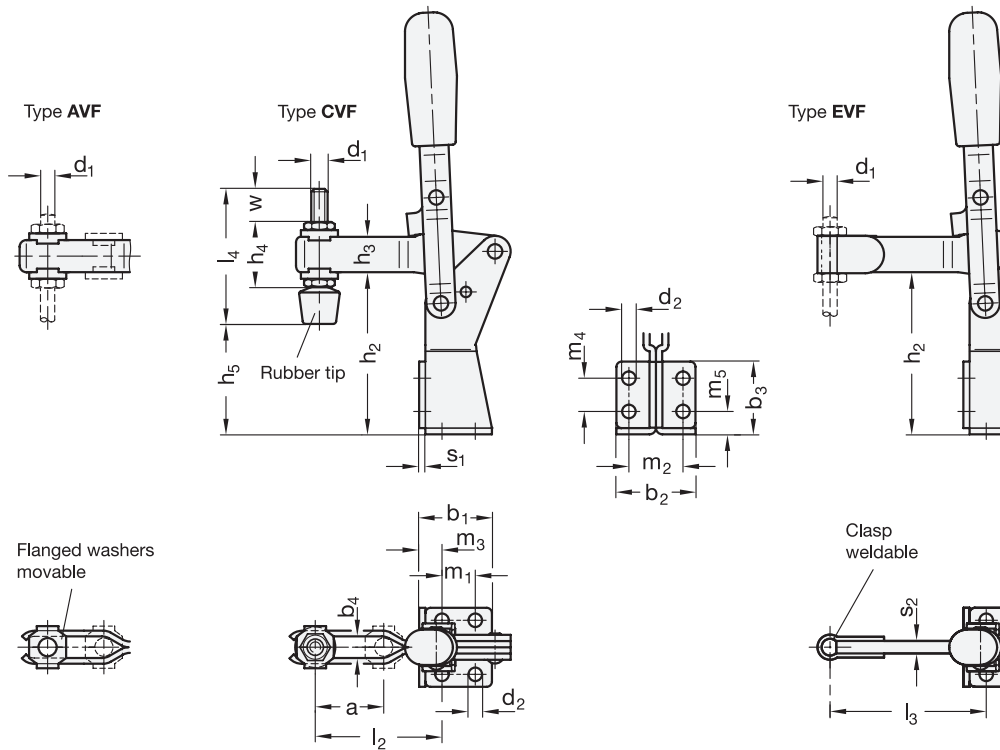

GN 812.1

Description	Size	FH in N	a ≈	b1	b2	b3	b4	d1	d2	h1 ≈	h2	h3	h4 ≈	h5 max.	l1 ≈	l2	l3 max.	l4	m1	m2	m3	m4	m5	r	s1	s2	w	⚖
GN 812.1-200-AVF	200	1600	36	35	38	35	8.5	M 8	6.5	203	77	17	-	-	103	61	-	-	16	26	11	16	11	95.5	3	-	-	390
GN 812.1-300-AVF	300	2400	50	48	48	51	10.2	M 10	8.5	258	105	20	-	-	130	75	-	-	28	30	11.5	30	12	121.5	3	-	-	680
GN 812.1-200-CVF	200	1600	36	35	38	35	8.5	M 8	6.5	203	77	17	29	53	103	61	-	68	16	26	11	16	11	95.5	3	-	21	450
GN 812.1-300-CVF	300	2400	50	48	48	51	10.2	M 10	8.5	258	105	20	35	76.5	130	75	-	77	28	30	11.5	30	12	121.5	3	-	21	700
GN 812.1-200-EVF	200	1600	-	35	38	35	-	M 8	6.5	203	77	17	-	-	105	-	85	-	16	26	11	16	11	97.5	3	6	-	400
GN 812.1-300-EVF	300	2400	-	48	48	51	-	M 10	8.5	258	105	20	-	-	132	-	100	-	28	30	11.5	30	12	123	3	8	-	690