

SERRATED PRESS FIT BUSHINGS

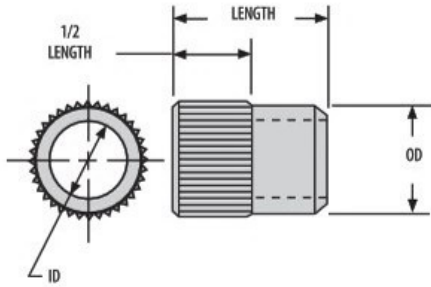

SP



APPLICATIONS:

Similar to a P bushing, but with top serrations to prevent rotation in soft materials. Recommended in high-torque situations for materials such as magnesium, aluminum, masonite, or wood. Finish-ground OD ensures accurate ID location. Serrations also resist axial force to prevent pushing the bushing through the jig plate.

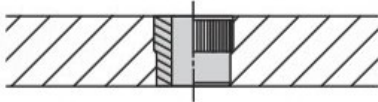

ORDERING EXAMPLES:

SP-26-16-.1875	Standard inch bushing, inch ID
SP-26-16-.1772	Standard inch bushing, mm ID (.1772 - 4.50mm)
SP-26-16-.1875 REAMER	Reamer tolerance on ID
SP-26-16-.1875 NCB	No counterbore on long bushings marked with * (no counterbore is standard on all other bushings)
SPM-8-12-4.50	Standard metric bushing

Standard prices apply only to bushings with a standard-drill-size ID within the stated ID range. See catalog back cover for standard drill sizes and their decimal equivalents. For prices on non-standard ID sizes, including reamer-tolerance and tap-guide bushings, please contact factory.

STANDARD ID TOLERANCES:

From #55 to 1/4"	+0.001/+0.0004	From 1 to 3mm	+0.002/+0.008mm
Over 1/4 to 3/4"	+0.001/+0.0005	Over 3 to 6mm	+0.004/+0.012mm
Over 3/4 to 1-1/2"	+0.002/+0.0006	Over 6 to 10mm	+0.005/+0.014mm
		Over 10 to 18mm	+0.006/+0.017mm
		Over 18 to 19mm	+0.007/+0.020mm (G6 tolerance)

REAMER ID TOLERANCES:

From #60 to 1/4"	+0.005/+0.0008	From 1 to 3mm	+0.006/+0.012mm
Over 1/4 to 1"	+0.006/+0.0010	Over 3 to 6mm	+0.010/+0.018mm
		Over 6 to 10mm	+0.013/+0.022mm
		Over 10 to 18mm	+0.016/+0.027mm
		Over 18 to 19mm	+0.020/+0.033mm (F6 tolerance)

ID RANGE	OD	LENGTH	ANSI PART NO.
.0520-.0995 #55-#39 1.35-2.50mm	13/64 .2031-.2029	1/4	SP-13-4
		5/16	SP-13-5
		3/8	SP-13-6
		1/2	SP-13-8
.0980-.1406 #40-9/64 2.50-3.50mm	1/4 .2500-.2498	1/4	SP-16-4
		5/16	SP-16-5
		3/8	SP-16-6
		1/2	SP-16-8
.1250-.1935 1/8-#10 3.20-4.90mm	5/16 .3125-.3123	1/4	SP-20-4
		5/16	SP-20-5
		3/8	SP-20-6
		1/2	SP-20-8
		3/4	SP-20-12
.1562-.2570 5/32-F 4.00-6.50mm	13/32 .4062-.4060	5/16	SP-26-5
		3/8	SP-26-6
		1/2	SP-26-8
		3/4	SP-26-12
		*1	SP-26-16
		5/16	SP-32-5
.1562-.3160 5/32-O 4.00-8.00mm	1/2 .5000-.4998	3/8	SP-32-6
		1/2	SP-32-8
		3/4	SP-32-12
		*1	SP-32-16
		3/8	SP-40-6
.3125-.4375 5/16-7/16 7.90-11.00mm	5/8 .6250-.6248	1/2	SP-40-8
		3/4	SP-40-12
		1	SP-40-16
		3/8	SP-48-6
.3125-.5312 5/16-17/32 8.00-13.00mm	3/4 .7500-.7498	1/2	SP-48-8
		3/4	SP-48-12
		1	SP-48-16
		3/8	SP-56-6
.5000-.6562 1/2-21/32 13.00-16.50mm	7/8 .8750-.8748	1/2	SP-56-8
		3/4	SP-56-12
		1	SP-56-16
		1/2	SP-64-8
.5000-.7656 1/2-49/64 13.00-19.00mm	1 1.0000-.9998	3/4	SP-64-12
		1	SP-64-16
		1-3/8	SP-64-22

* **INFO+**: Counterbored, leaving correct drill-bearing length and clearance (see page 551 for bearing length).

Visit Our Redesigned Website

- Product Catalog
- Customer Service
- Free CAD Drawings
- Videos
- Engineering Resources



Visit CarrLane.com