

HAND KNOB ASSEMBLIES

KNOB: 319 ALUMINUM ALLOY
SCREW: 1215 STEEL, ZINC PLATED CLEAR CHROMATE

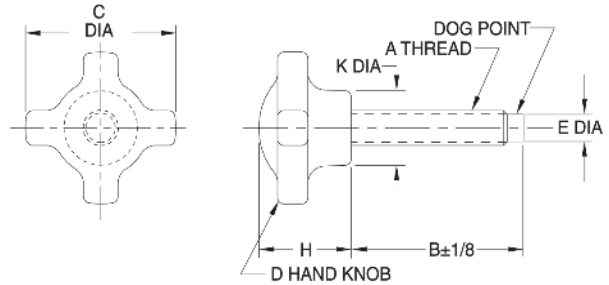

3

Classic, easy-to-grip aluminum knob with an integral steel clamping screw. Four-prong design provides a firm grip for applications requiring quick tightening and high torque. Choice of three knob sizes. Available in thread sizes from 1/4-20 to 3/4-10 (M6 to M20 in metric), most in a choice of several thread lengths.

INCH

PART NO.	A	B	C DIA	D	E DIA	H	K DIA
CL-1-HK2T	1/4-20	1	1-3/4	CL-25-HK-2A	.15	1-1/8	3/4
CL-2-HK2T		1-1/2					
CL-2A-HK2T		2					
CL-2B-HK2T		3					
CL-3A-HK2T	5/16-18	1	1-3/4	CL-25-HK-2A	.20	1-1/8	3/4
CL-3-HK2T		1-3/4					
CL-4-HK2T		2-1/2					
CL-4A-HK2T		3					
CL-5A-HK4T	3/8-16	1	2-1/8	CL-45-HK-4A	.25	1-3/8	1
CL-5B-HK4T		1-1/2					
CL-5-HK4T		2					
CL-6-HK4T		2-1/2					
CL-6A-HK4T	1/2-13	3	2-1/8	CL-45-HK-4A	.34	1-3/8	1
CL-7A-HK4T		1					
CL-7B-HK4T		1-1/2					
CL-7C-HK4T		2					
CL-7-HK4T	1/2-13	2-1/2	2-1/8	CL-45-HK-4A	.34	1-3/8	1
CL-8-HK4T		3					
CL-9-HK6T		1-3/4					
CL-10-HK6T	5/8-11	3	2-3/4	CL-65-HK-6A	.46	1-1/2	1-3/8
CL-12-HK6T	3/4-10	3	2-3/4	CL-65-HK-6A	.56	1-1/2	1-3/8

METRIC

PART NO.	A THREAD	THREAD PITCH (mm)	B (mm)	C DIA (mm)	D	E DIA (mm)	H (mm)	K DIA (mm)
CLM-1-HK2T	M6	1	25	44	CL-25-HK-2A	4.4	29	19
CLM-2-HK2T			40					
CLM-3A-HK2T	M8	1.25	25	44	CL-25-HK-2A	5.9	29	19
CLM-3-HK2T			45					
CLM-4-HK2T	M10	1.5	65	54	CL-45-HK-4A	6.9	35	25
CLM-5A-HK4T			25					
CLM-5B-HK4T			40					
CLM-5-HK4T			50					
CLM-6-HK4T	M12	1.75	65	54	CL-45-HK-4A	8.9	35	25
CLM-7A-HK4T			25					
CLM-7B-HK4T			40					
CLM-7C-HK4T			50					
CLM-8-HK4T	M16	2	75	70	CL-65-HK-6A	11.9	38	35
CLM-9-HK6T			45					
CLM-10-HK6T			75					
CLM-12-HK6T	M20	2.5	75	70	CL-65-HK-6A	14.9	38	35

EXTRUDED HAND KNOB ASSEMBLIES

HAND KNOB: EXTRUDED ALUMINUM, GREEN ANODIZE,
SCREW: 1215 STEEL, ZINC PLATED CLEAR CHROMATE

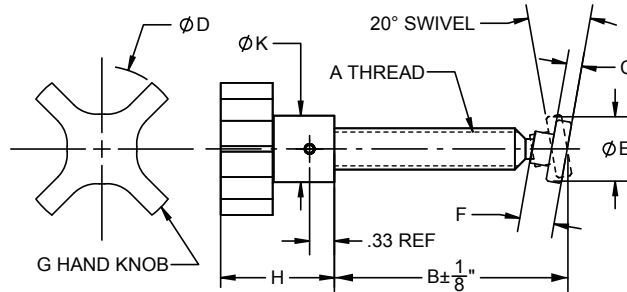

Extruded Hand knob assembly with a removable swivel foot. Clamping screw is securely pinned in the knob. Four-prong design provides a firm grip for applications requiring quick tightening and high torque. Made in U.S.A.

3

INCH

PART NO.	A THREAD	B	C	D DIA	E DIA	F	G	H	K DIA
CL-1-KESA	1/4-20	1-1/4	1/8	1	3/8	5/16	CL-4T-HKE-00	7/8	.51
CL-2-KESA	1/4-20	2	1/8	1	3/8	5/16	CL-4T-HKE-00	7/8	.51
CL-2A-KESA	1/4-20	2	1/8	1-1/2	3/8	5/16	CL-4T-HKE-20	1-1/8	.75
CL-3-KESA	5/16-18	1-1/2	5/32	1-1/2	1/2	11/32	CL-5T-HKE-20	1-1/8	.75
CL-4-KESA	5/16-18	2-1/4	5/32	1-1/2	1/2	11/32	CL-5T-HKE-20	1-1/8	.75
CL-4A-KESA	5/16-18	2-3/4	5/32	1-1/2	1/2	11/32	CL-5T-HKE-20	1-1/8	.75
CL-5-KESA	3/8-16	2-1/16	3/16	2	9/16	7/16	CL-6T-HKE-30	1-3/8	.81
CL-6-KESA	3/8-16	2-13/16	3/16	2	9/16	7/16	CL-6T-HKE-30	1-3/8	.81
CL-7-KESA	3/8-16	3-9/16	3/16	2	9/16	7/16	CL-6T-HKE-30	1-3/8	.81
CL-8-KESA	1/2-13	2-13/16	3/16	2	3/4	27/64	CL-8T-HKE-30	1-3/8	.81
CL-9-KESA	1/2-13	3-9/16	3/16	2	3/4	27/64	CL-8T-HKE-30	1-3/8	.81
CL-10-KESA	1/2-13	4-5/16	3/16	2	3/4	27/64	CL-8T-HKE-30	1-3/8	.81
CL-11-KESA	5/8-11	3-5/16	7/32	2-1/2	15/16	33/64	CL-10T-HKE-40	1-1/2	1.00
CL-13-KESA	5/8-11	4-13/16	7/32	2-1/2	15/16	33/64	CL-10T-HKE-40	1-1/2	1.00
CL-14-KESA	3/4-10	3-5/16	7/32	2-1/2	15/16	33/64	CL-12T-HKE-40	1-1/2	1.00
CL-16-KESA	3/4-10	4-13/16	7/32	2-1/2	15/16	33/64	CL-12T-HKE-40	1-1/2	1.00

INCH

PART NO.	A THREAD	THREAD PITCH (mm)	B (mm)	C (mm)	D DIA (mm)	E DIA (mm)	F (mm)	G	H (mm)	K DIA (mm)
CLM-1-KESA	M6	1	25	3.2	25	9.5	7.5	CLM-6T-HKE-00	22	13
CLM-2-KESA	M6	1	50	3.2	25	9.5	7.5	CLM-6T-HKE-00	22	13
CLM-3-KESA	M8	1.25	40	4	44	12.5	9	CLM-8T-HKE-20	28	19
CLM-4-KESA	M8	1.25	60	4	44	12.5	9	CLM-8T-HKE-20	28	19
CLM-5-KESA	M10	1.5	50	4.8	51	14.5	11	CLM-10T-HKE-30	35	21
CLM-6-KESA	M10	1.5	90	4.8	51	14.5	11	CLM-10T-HKE-30	35	21
CLM-7-KESA	M12	1.75	70	4.8	64	19	10.5	CLM-12T-HKE-40	38	25
CLM-8-KESA	M12	1.75	110	4.8	64	19	10.5	CLM-12T-HKE-40	38	25
CLM-9-KESA	M16	2	80	5.5	64	23.5	13	CLM-16T-HKE-40	38	25
CLM-10-KESA	M16	2	120	5.5	64	23.5	13	CLM-16T-HKE-40	38	25

SWIVEL-WASHER HAND KNOB ASSEMBLIES

KNOB: 319 ALUMINUM ALLOY
 SCREW: 1215 STEEL, BLACK OXIDE FINISH.
 WASHER: MILD STEEL

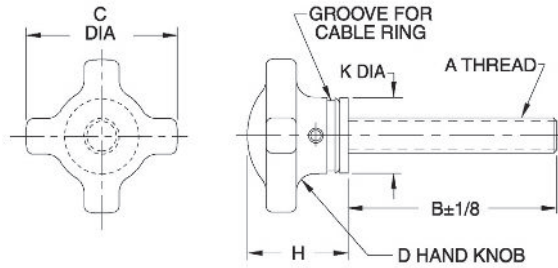

ASSEMBLY WITH STEEL WASHER (INCH)

PART NO.	A	B	C DIA	D	H	K DIA	CABLE RING SIZE
CL-1-SHK2T	1/4-20	1	1-3/4	CL-25-HK-2A	1.33	3/4	CL-11-KR
CL-2-SHK2T		1-1/2					
CL-2A-SHK2T		2					
CL-2B-SHK2T	5/16-18	3	1-3/4	CL-25-HK-2A	1.34	3/4	CL-11-KR
CL-3A-SHK2T		1					
CL-3-SHK2T		1-3/4					
CL-4-SHK2T	3/8-16	2-1/2	2-1/8	CL-45-HK-4A	1.47	1	CL-14-KR
CL-4A-SHK2T		3					
CL-5A-SHK4T		1					
CL-5B-SHK4T	1/2-13	1-1/2	2-1/8	CL-45-HK-4A	1.53	1	CL-14-KR
CL-5-SHK4T		2					
CL-6-SHK4T		2-1/2					
CL-6A-SHK4T	5/8-11	3	2-3/4	CL-65-HK-6A	1.66	1-3/8	CL-19-KR
CL-7A-SHK4T		1					
CL-7B-SHK4T		1-1/2					
CL-7C-SHK4T	3/4-10	2	2-3/4	CL-65-HK-6A	1.77	1-3/8	CL-19-KR
CL-7-SHK4T		2-1/2					
CL-8-SHK4T		3					
CL-9-SHK6T	3/4-10	1-3/4	2-3/4	CL-65-HK-6A	1.66	1-3/8	CL-19-KR
CL-10-SHK6T		3					
CL-12-SHK6T	3/4-10	3	2-3/4	CL-65-HK-6A	1.77	1-3/8	CL-19-KR

ASSEMBLY WITH NYLON WASHER (INCH)

PART NO.	A	B	C DIA	D	H	K DIA	CABLE RING SIZE
CL-1-SHK2TN	1/4-20	1	1-3/4	CL-25-HK-2A	1.33	3/4	CL-11-KR
CL-2-SHK2TN		1-1/2					
CL-3-SHK2TN	5/16-18	1-3/4	1-3/4	CL-25-HK-2A	1.34	3/4	CL-11-KR
CL-5A-SHK4TN	3/8-16	1	2-1/8	CL-45-HK-4A	1.47	1	CL-14-KR
CL-7A-SHK4TN	1/2-13	1	2-1/8	CL-45-HK-4A	1.53	1	CL-14-KR
CL-7B-SHK4TN		1-1/2					

Hand-knob assembly with a captive, freely rotating washer to prevent marring in clamping applications. Four-prong design provides a firm grip for applications requiring quick tightening and high torque. Plain-end screw with no dogpoint. Choice of three knob sizes. Available in thread sizes from 1/4-20 to 3/4-10, most in a choice of several thread lengths.

KNOB SHOE ASSEMBLIES

HAND KNOB: EXTRUDED ALUMINUM, GREEN ANODIZE
 SCREW: 1215 STEEL, BLACK OXIDE FINISH OR ZINC PLATED CLEAR CHROMATE
 FOOT: 1215 STEEL, BLACK OXIDE FINISH OR ZINC PLATED YELLOW CHROMATE (OR DELRIN®)

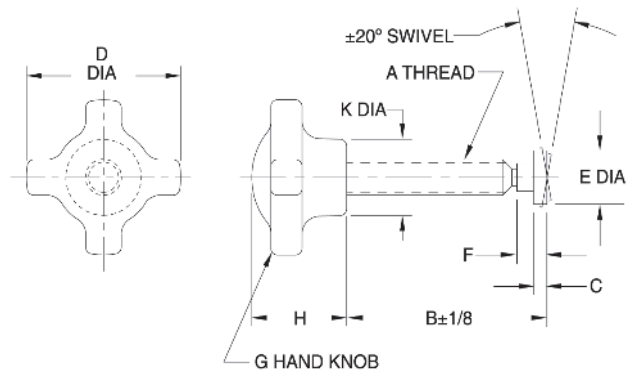

This hand-knob assembly features an integral steel clamping screw with a removable swivel foot. Four-prong design provides a firm grip for applications requiring quick tightening and high torque. Choice of four knob sizes. Available in thread sizes from 1/4-20 to 3/4-10 (M6 to M20 in metric), most in a choice of several thread lengths.

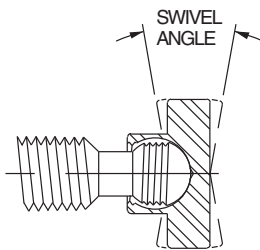

Knob Shoe Assemblies use our patented left-hand-thread swivel-foot system. The ball end of the body screws into the foot for easy installation and removal. Once the ball threads pass beyond the foot threads, the foot can rotate and pivot freely (20° total angle). Foot threads are left-hand to positively prevent accidental backout during use. Delrin® feet are optional. To order with a Delrin® foot, add "N" to the part number, e.g. CL-1-KSAN. Note: Delrin® feet are not threaded – they snap on and off. INFO+: For other foot types, see Feet for Swivel Screws on page 122 (order separately).

INCH

PART NO.	A	B	C	D DIA	E DIA	F	G	H	K DIA
CL-1-KSA	1/4-20	1-1/4	1/8	1-1/8	3/8	5/16	CL-85-HK-8A	7/8	9/16
CL-2-KSA		2							
CL-2A-KSA	1/4-20	2	1/8	1-3/4	3/8	5/16	CL-25-HK-2A	1-1/8	3/4
CL-3-KSA		1-1/2							
CL-4-KSA	5/16-18	2-1/4	5/32	1-3/4	1/2	11/32	CL-25-HK-2A	1-1/8	3/4
CL-4A-KSA		2							
CL-5-KSA	3/8-16	2-1/16	3/16	2-1/8	9/16	7/16	CL-45-HK-4A	1-3/8	1
CL-6-KSA		2-13/16							
CL-7-KSA	1/2-13	3-9/16	7/32	2-3/4	3/4	27/64	CL-65-HK-6A	1-1/2	1-3/8
CL-8-KSA		2-13/16							
CL-9-KSA	5/8-11	3-9/16	7/32	2-3/4	15/16	33/64	CL-65-HK-6A	1-1/2	1-3/8
CL-10-KSA		4-5/16							
CL-11-KSA	3/4-10	3-5/16	7/32	2-3/4	15/16	33/64	CL-65-HK-6A	1-1/2	1-3/8
CL-13-KSA		4-13/16							
CL-14-KSA	3/4-10	3-5/16	7/32	2-3/4	15/16	33/64	CL-65-HK-6A	1-1/2	1-3/8
CL-16-KSA		4-13/16							

METRIC

PART NO.	A THREAD	THREAD PITCH (mm)	B (mm)	C (mm)	D DIA (mm)	E DIA (mm)	F (mm)	G	H (mm)	K DIA (mm)
CLM-1-KSA	M6	1	25	3.2	29	9.5	7.5	CL-85-HK-8A	22	14
CLM-2-KSA			50							
CLM-3-KSA	M8	1.25	40	4	44	12.5	9	CL-25-HK-2A	29	19
CLM-4-KSA			60							
CLM-5-KSA	M10	1.5	50	4.8	54	14.5	11	CL-45-HK-4A	35	25
CLM-6-KSA			90							
CLM-7-KSA	M12	1.75	70	5.5	70	19	10.5	CL-45-HK-4A	38	35
CLM-8-KSA			110							
CLM-9-KSA	M16	2	80	5.5	70	23.5	13	CL-65-HK-6A	38	35
CLM-10-KSA			120							